

PAGE 2	PAGE 3	PAGE 4	PAGE 5	PAGE 6
PAGE 7	PAGE 8	PAGE 9	PAGE 10	PAGE 11
PAGE 12	PAGE 13	PAGE 14	PAGE 15	PAGE 16
	PAGE 17	PAGE 18	PAGE 19	
	PAGE 20	PAGE 21	PAGE 22	

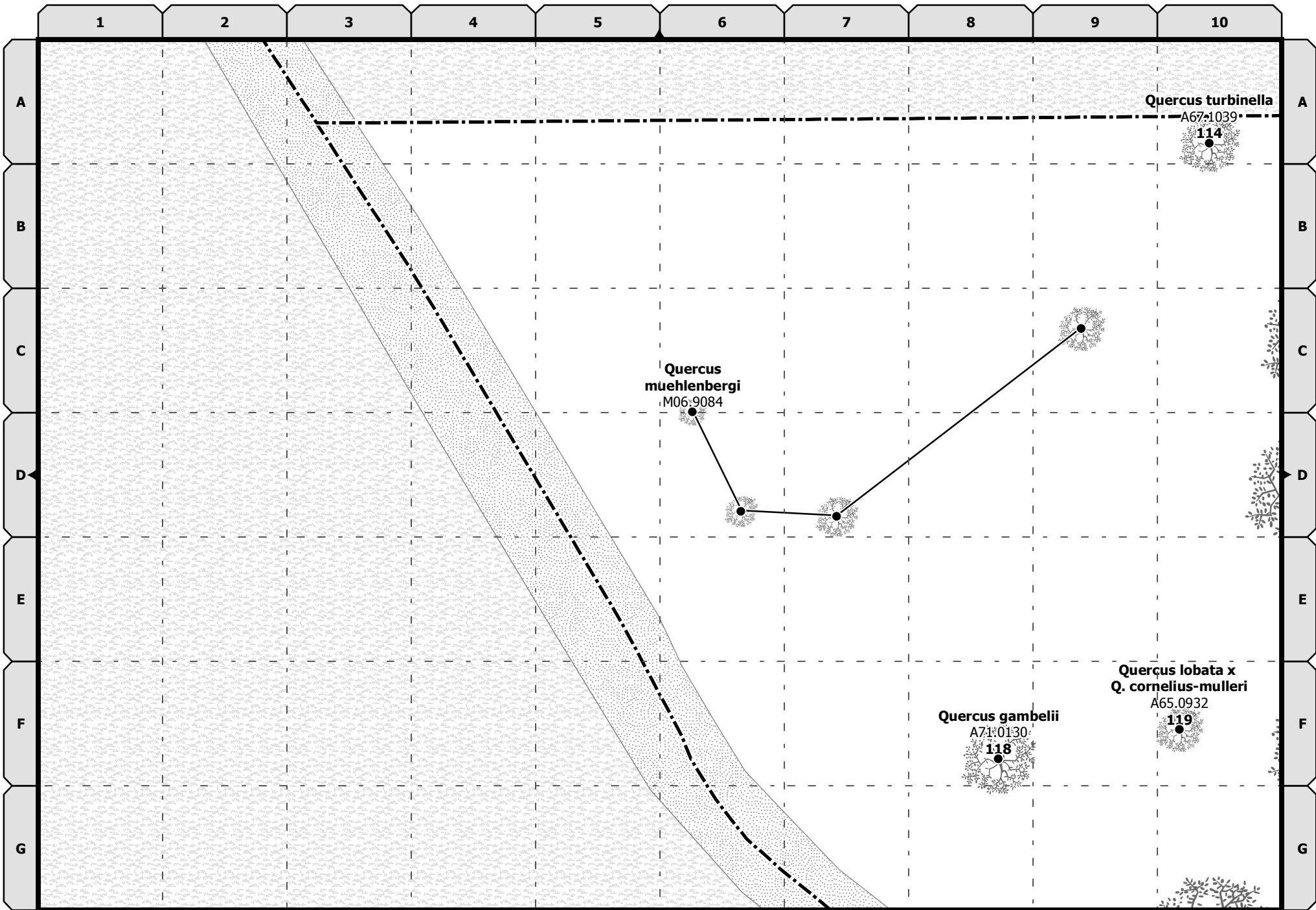

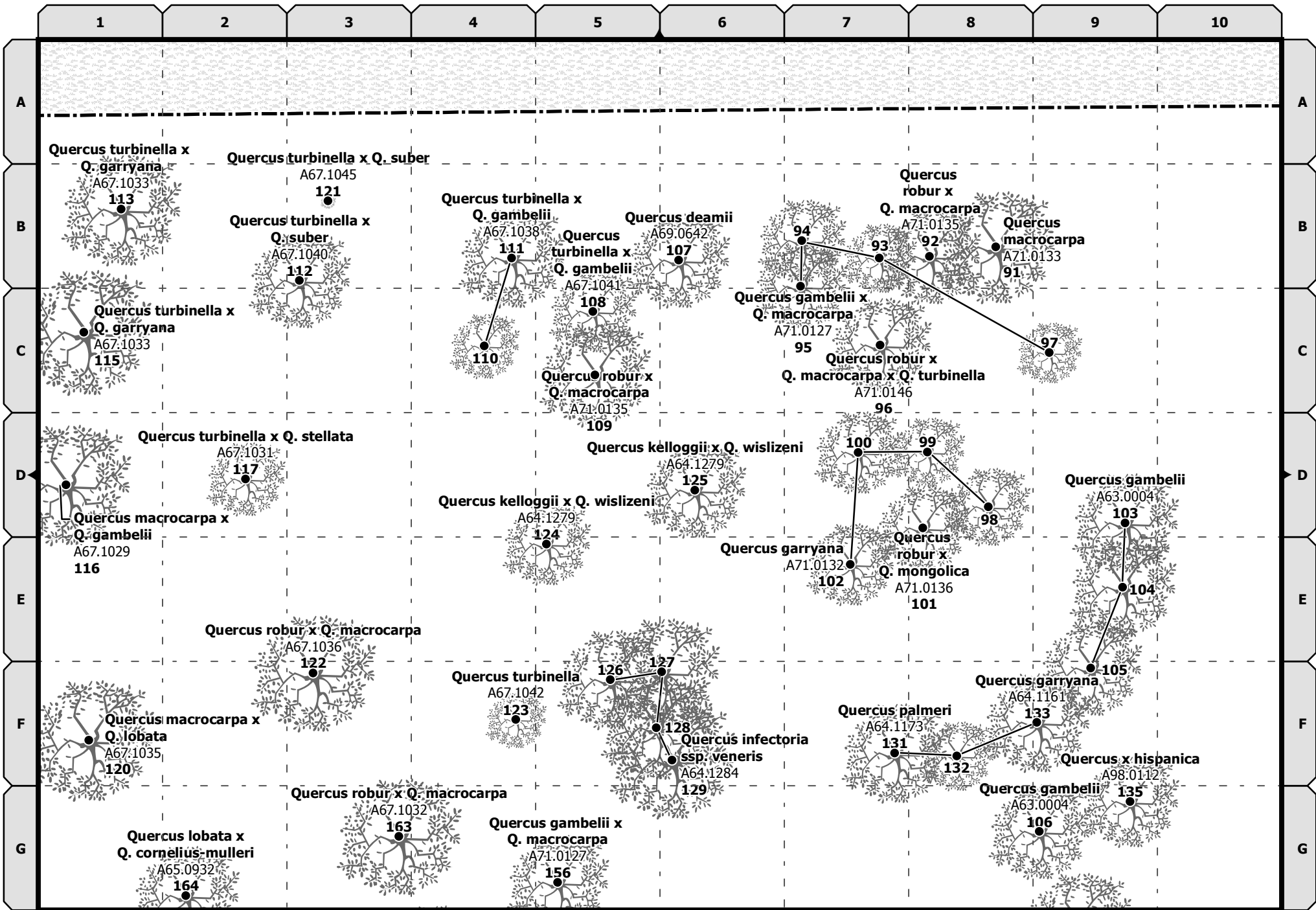

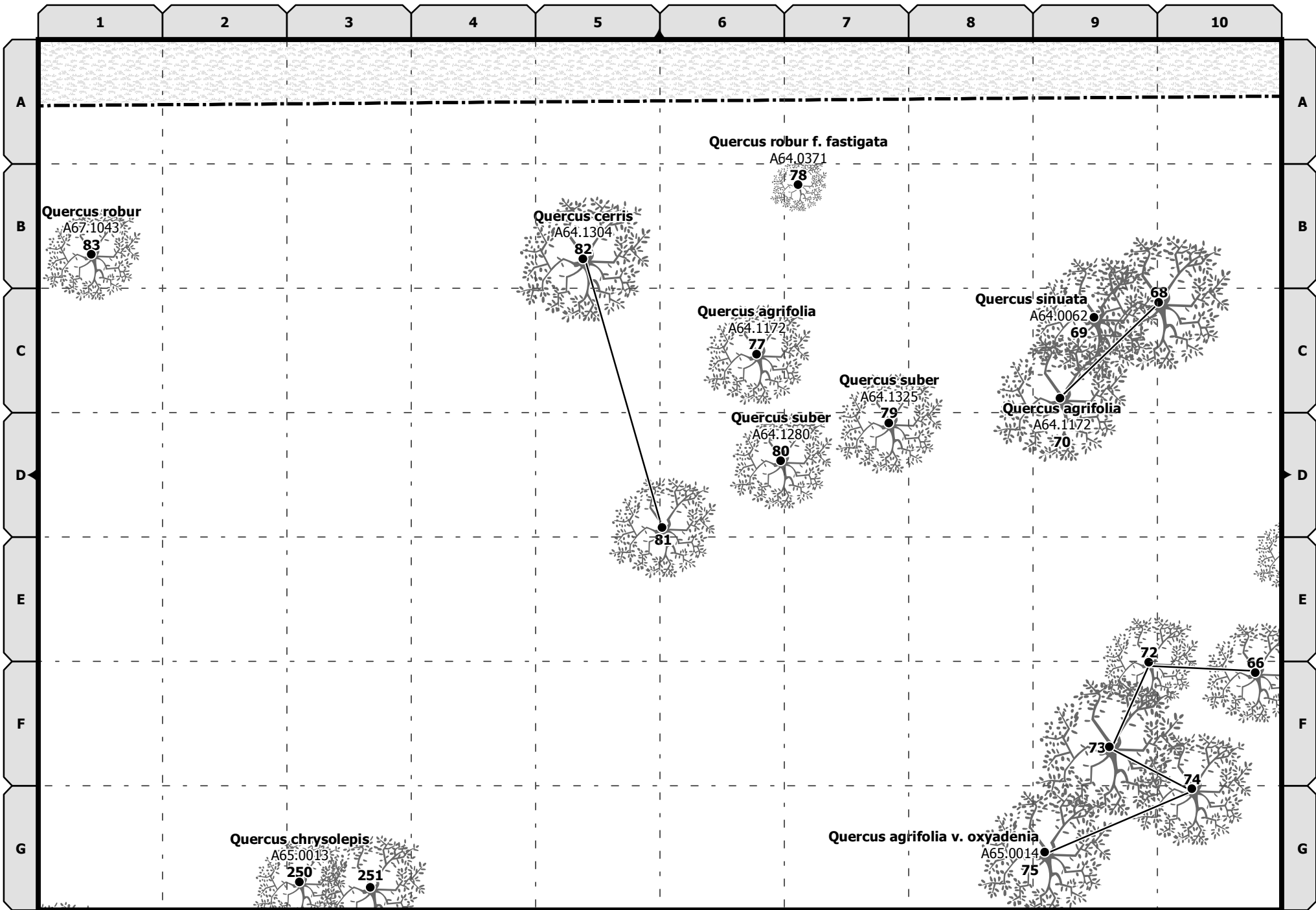

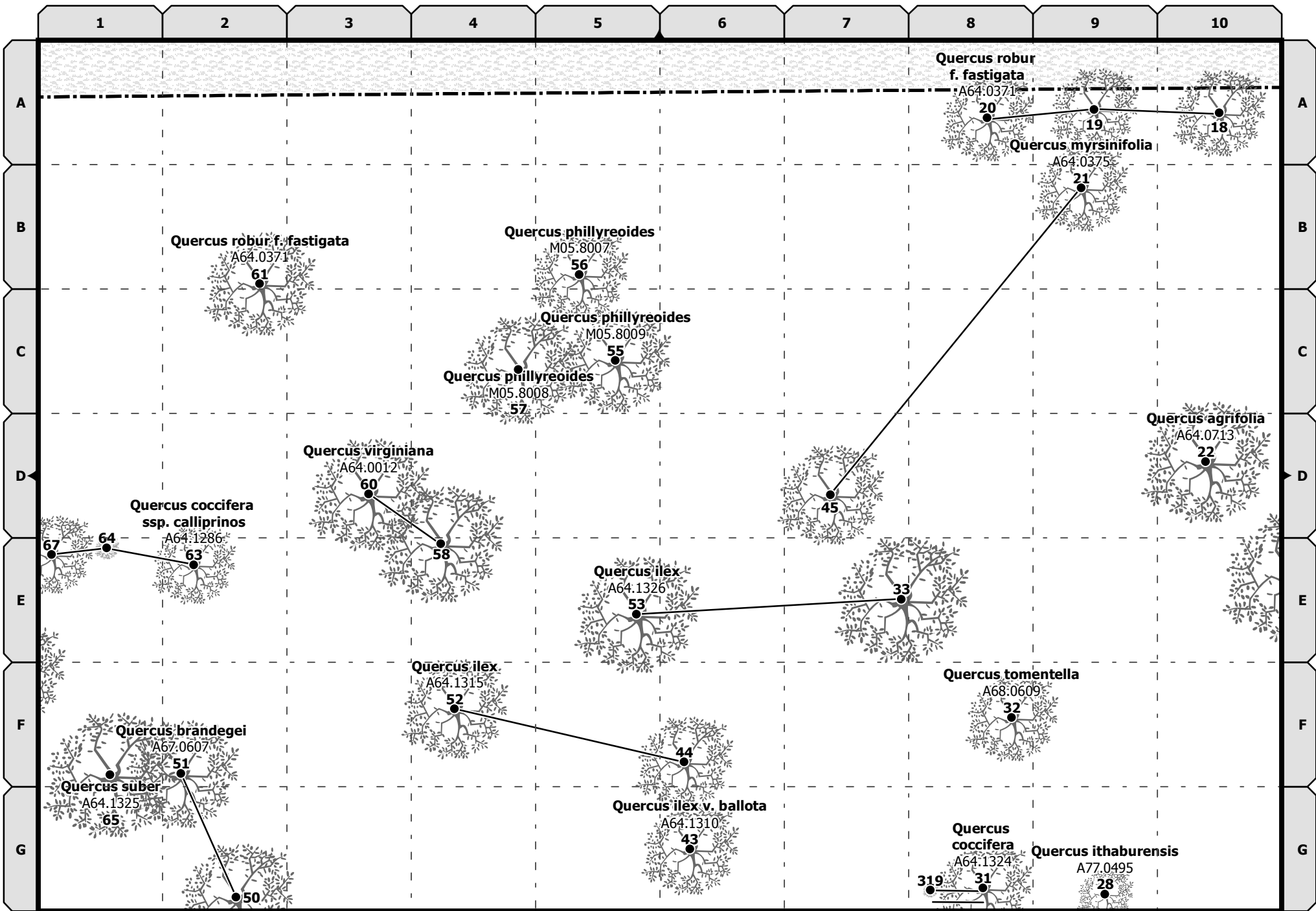

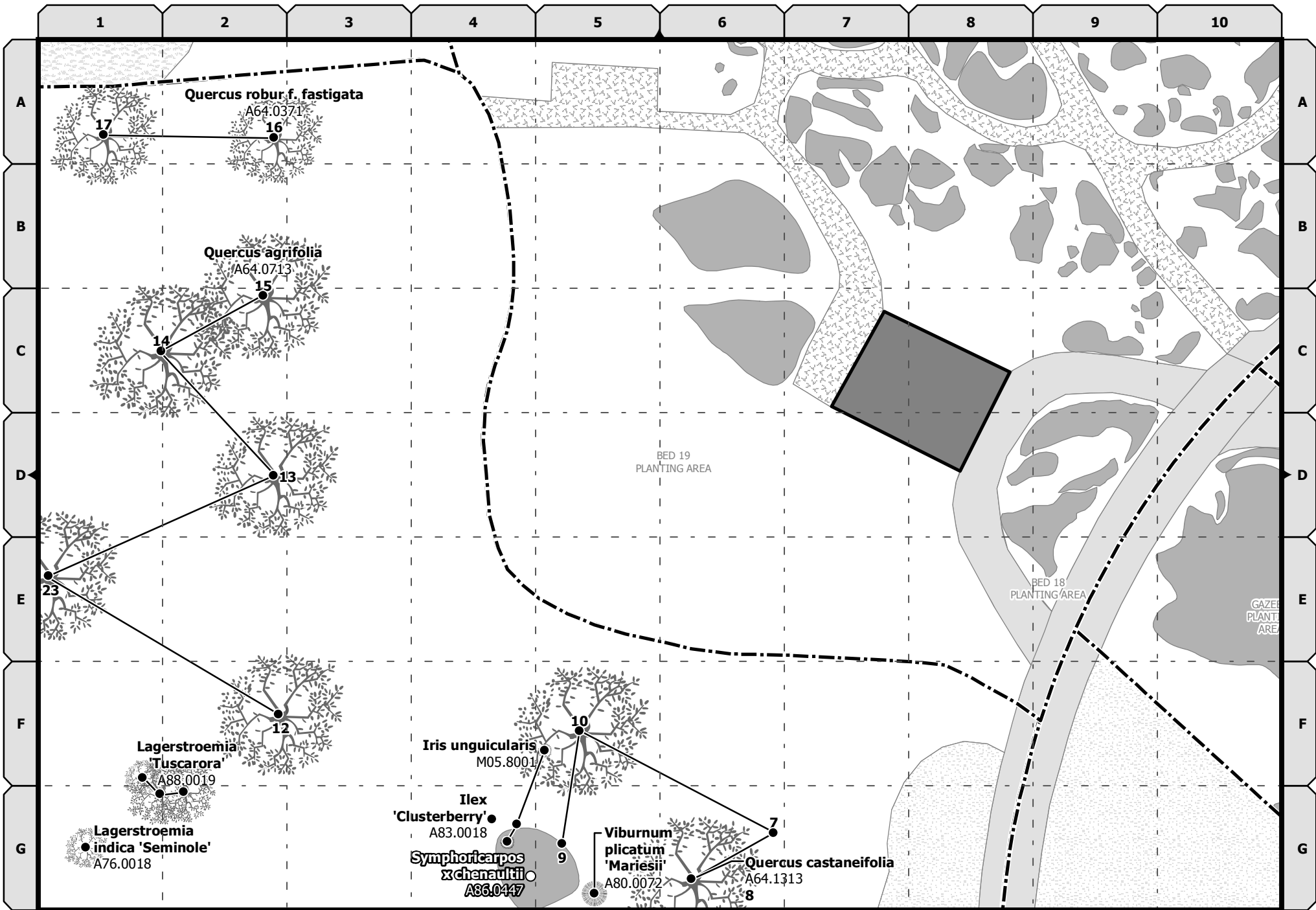

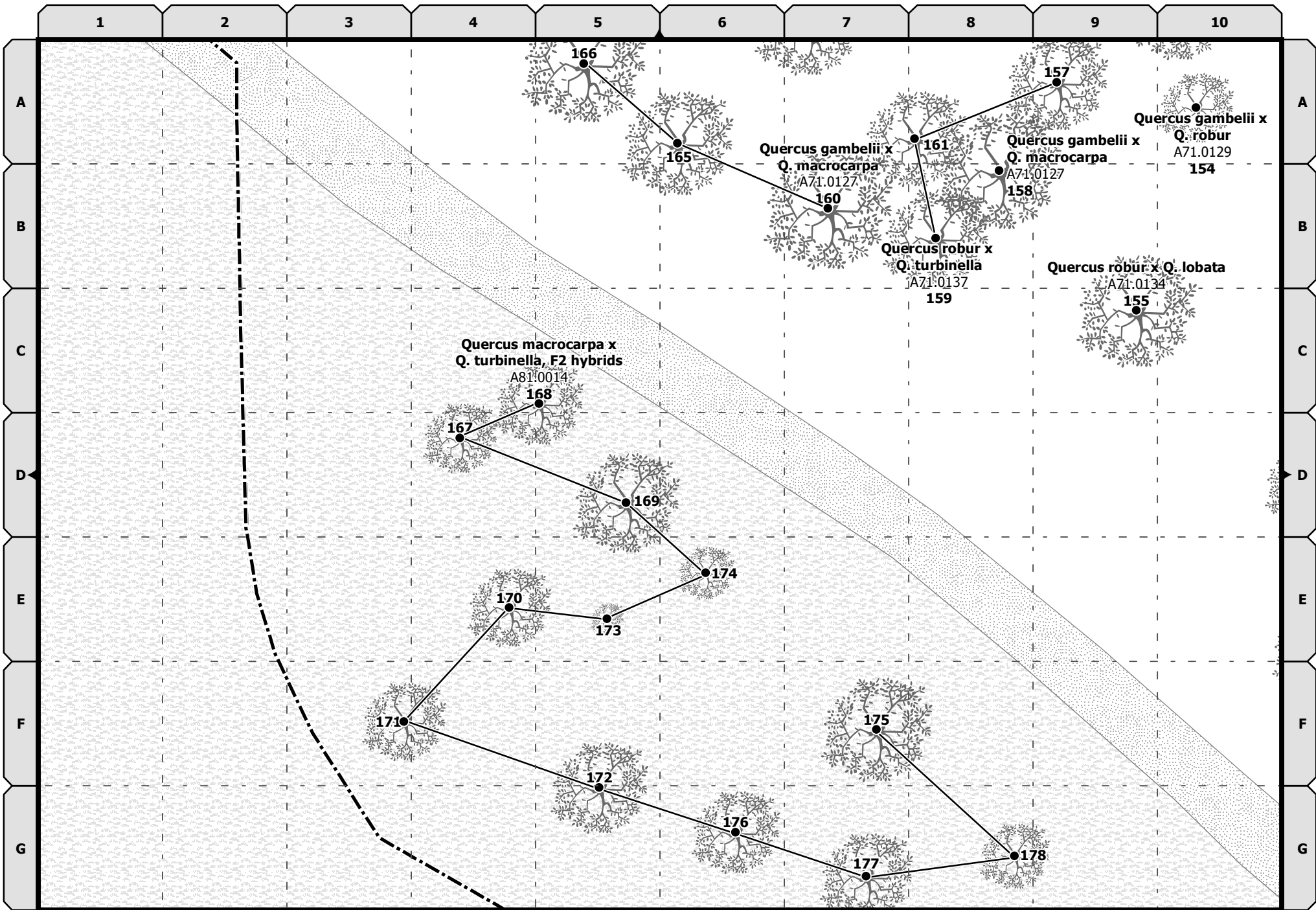

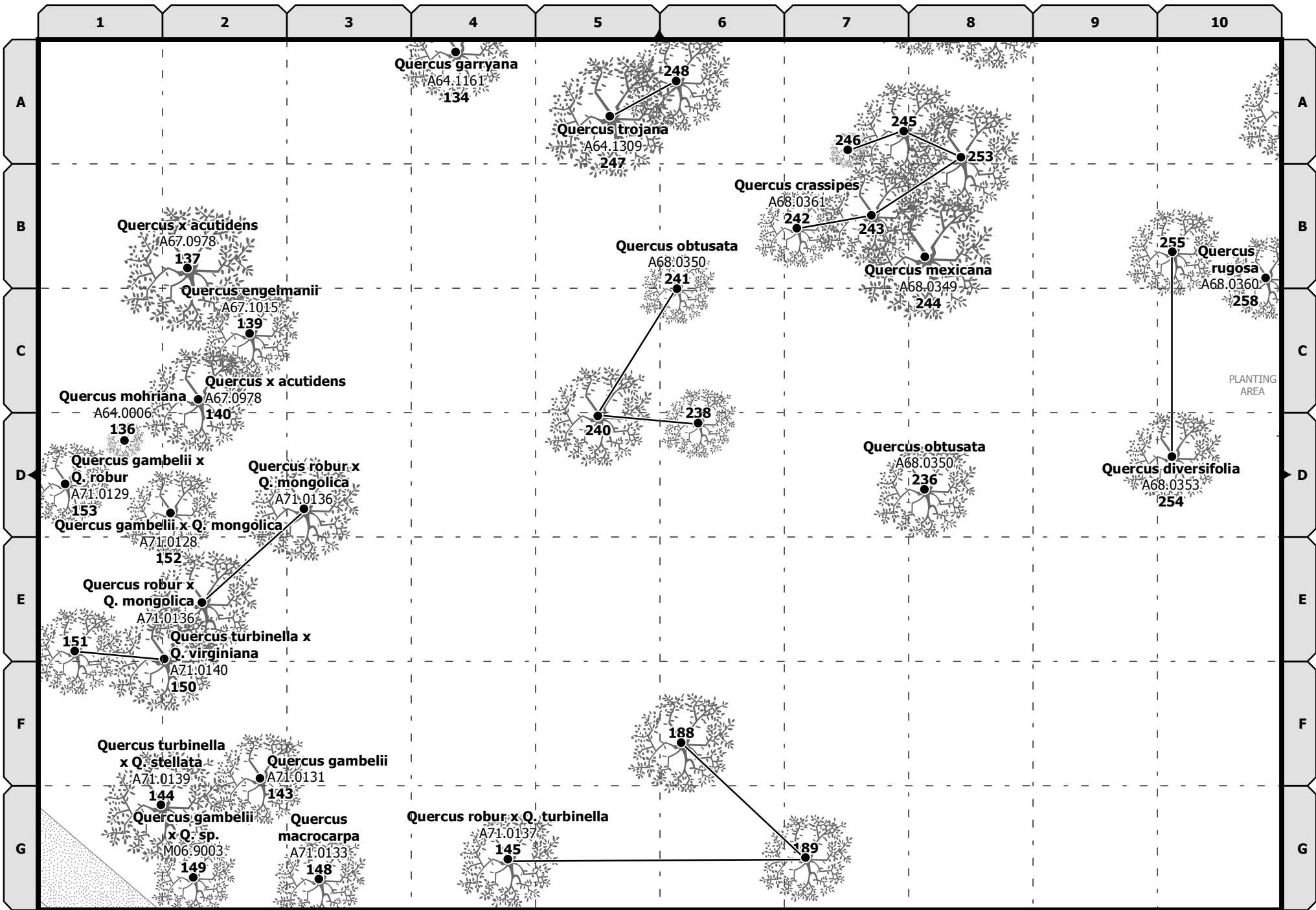

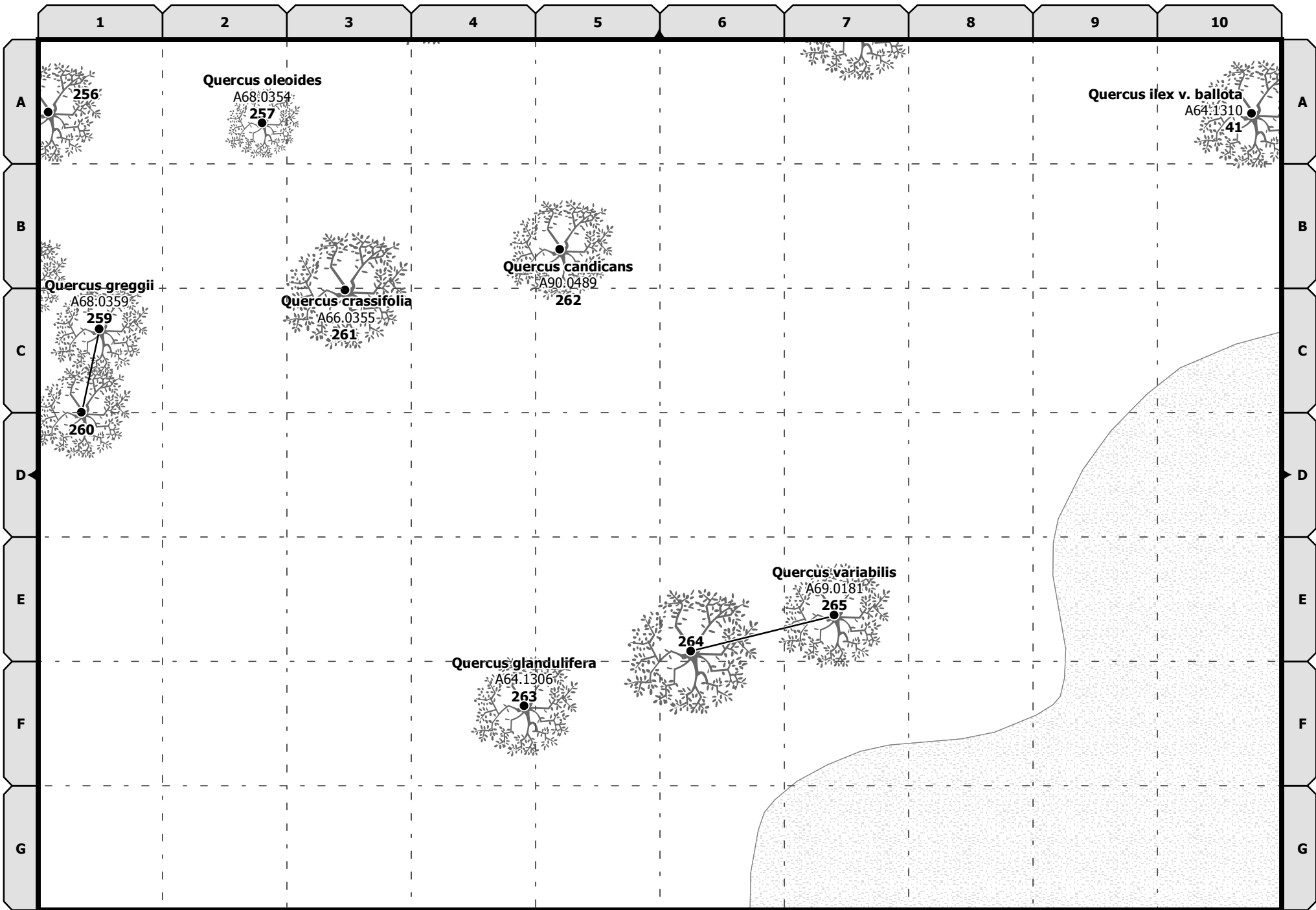

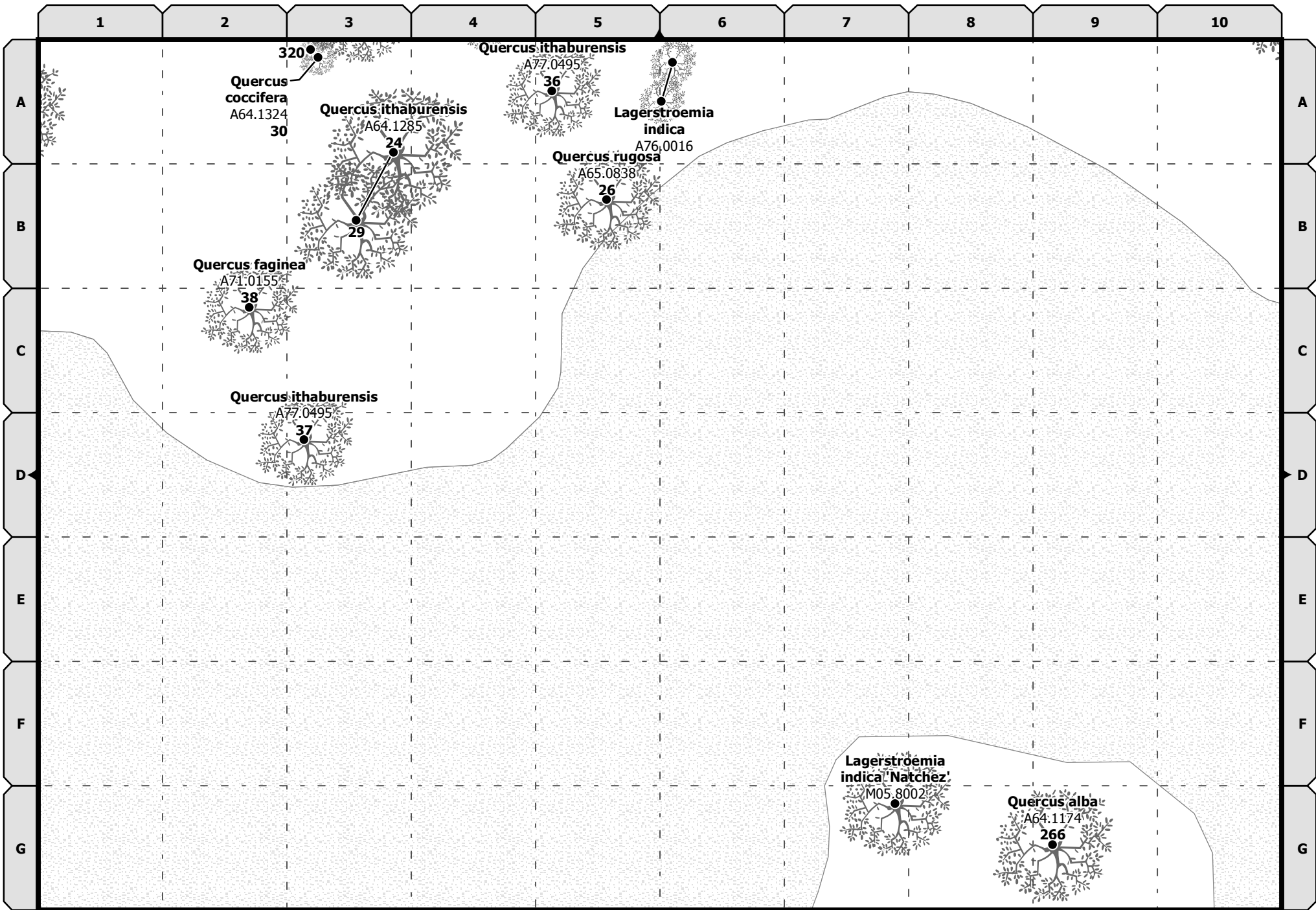

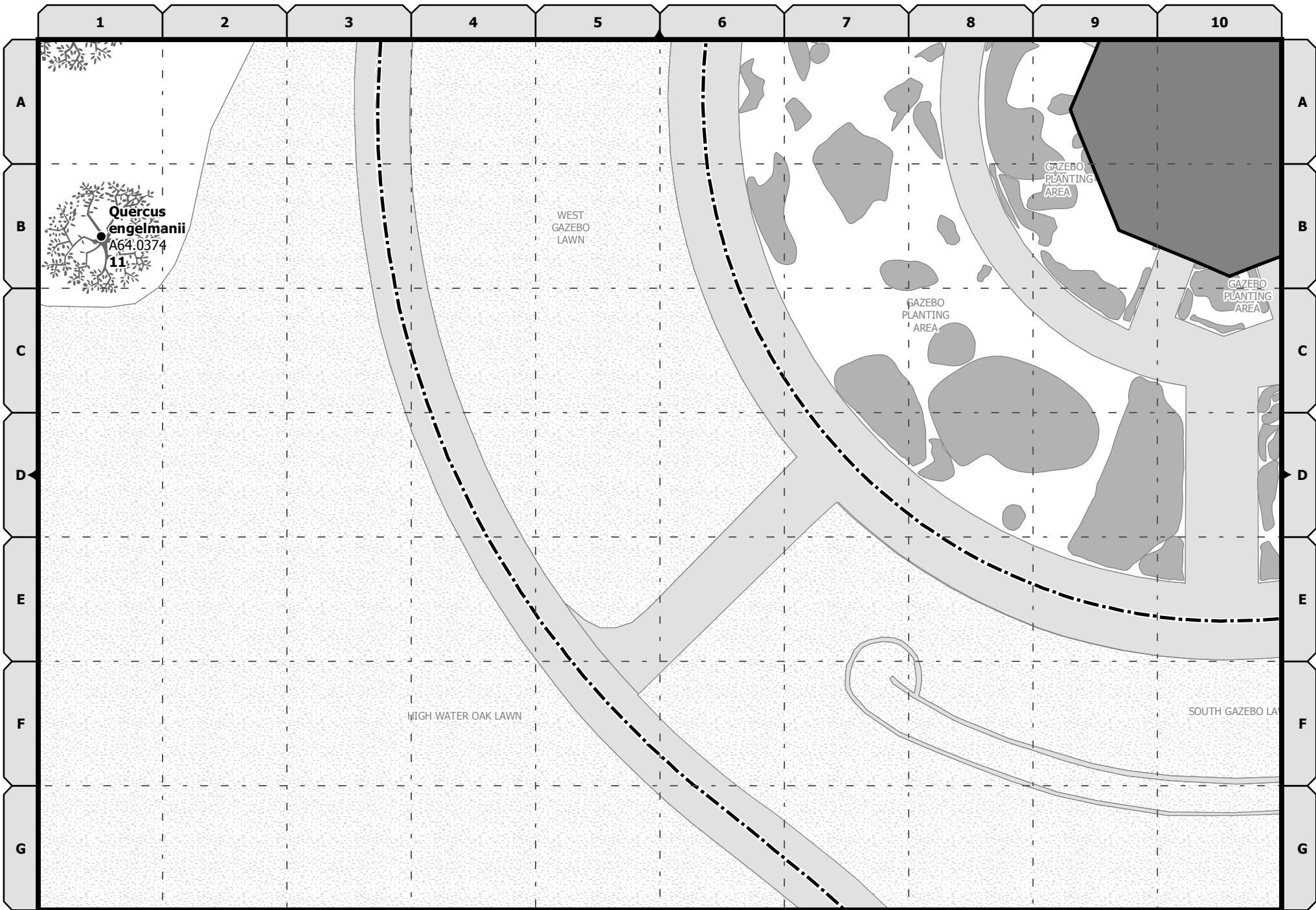

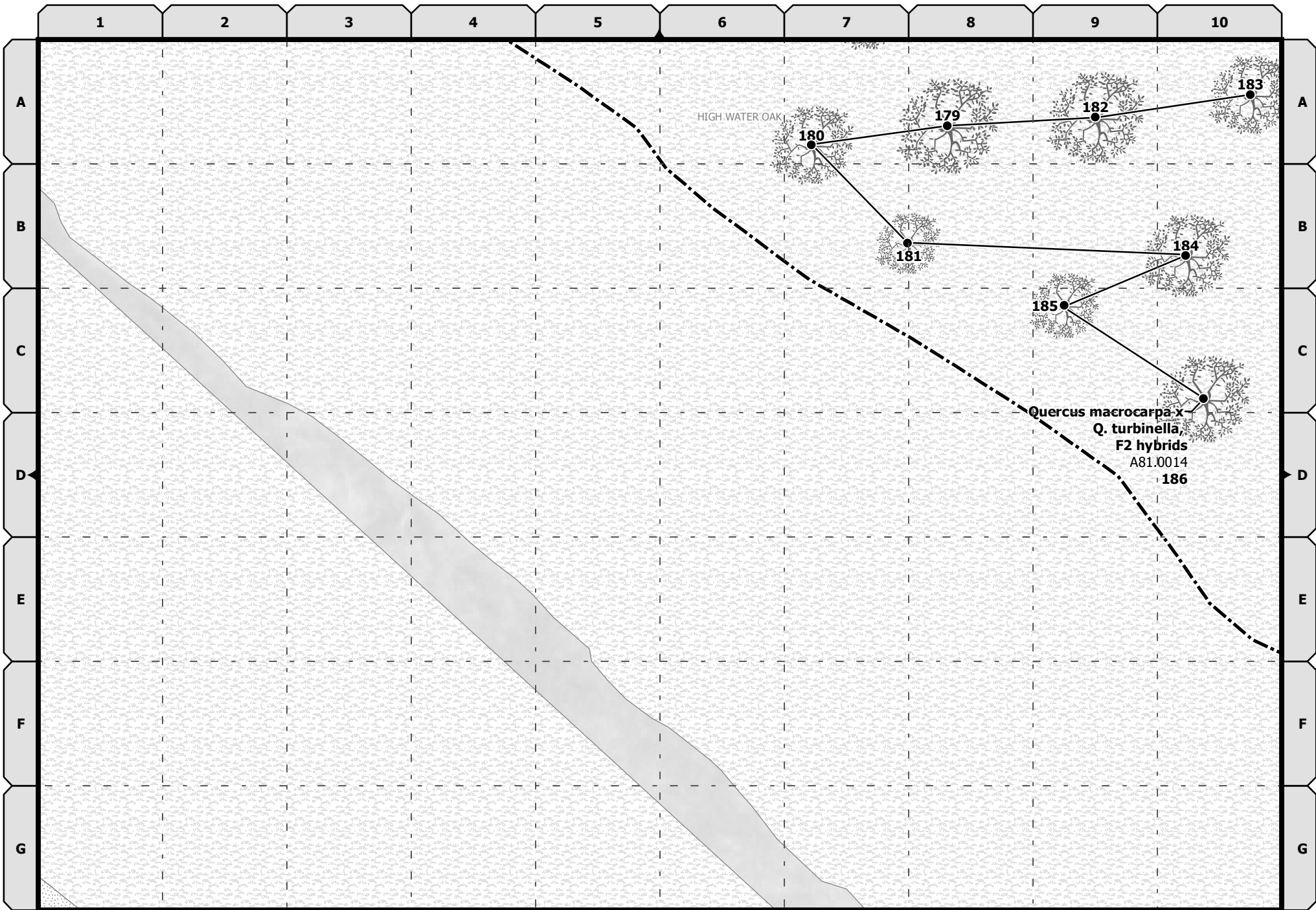

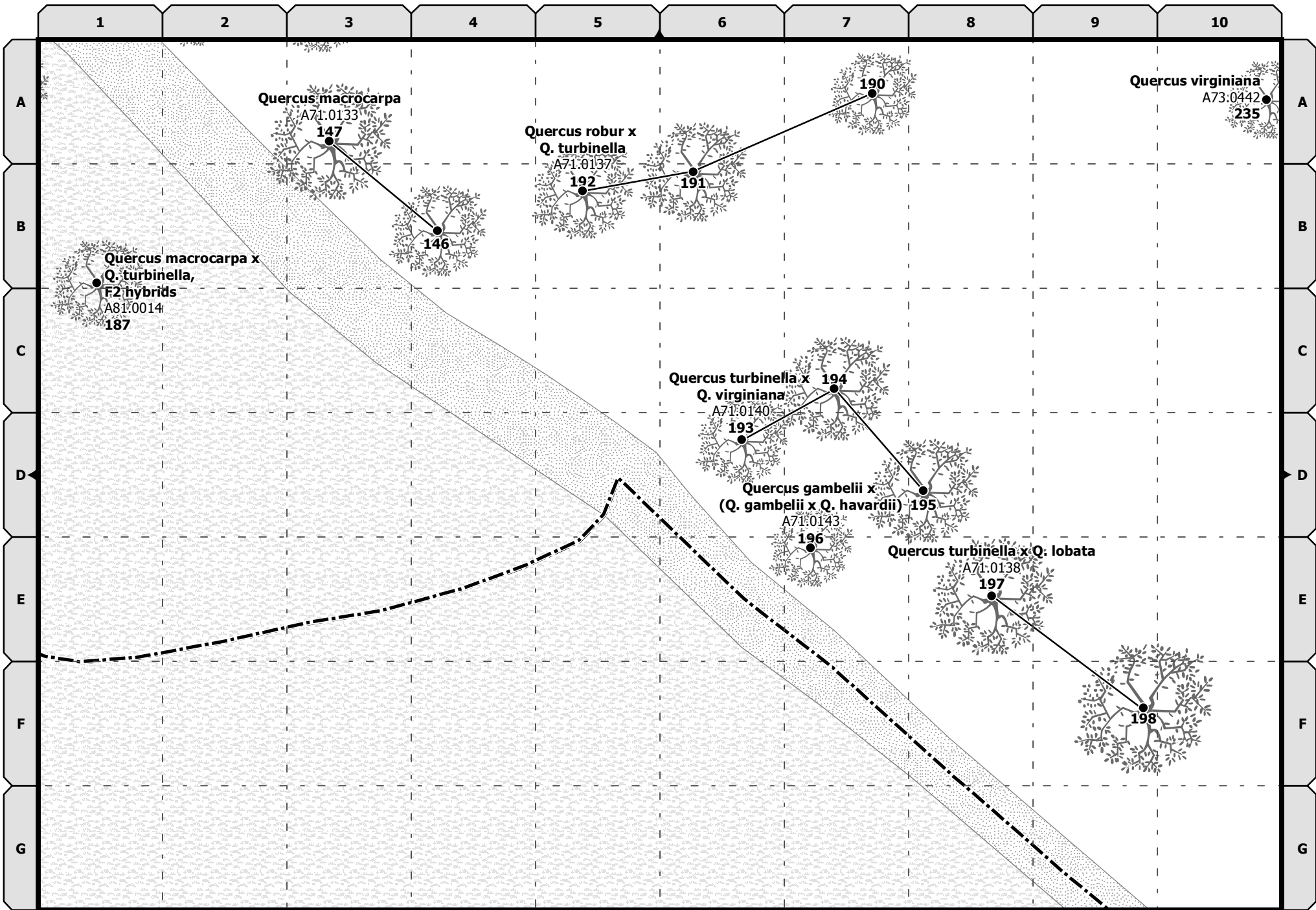

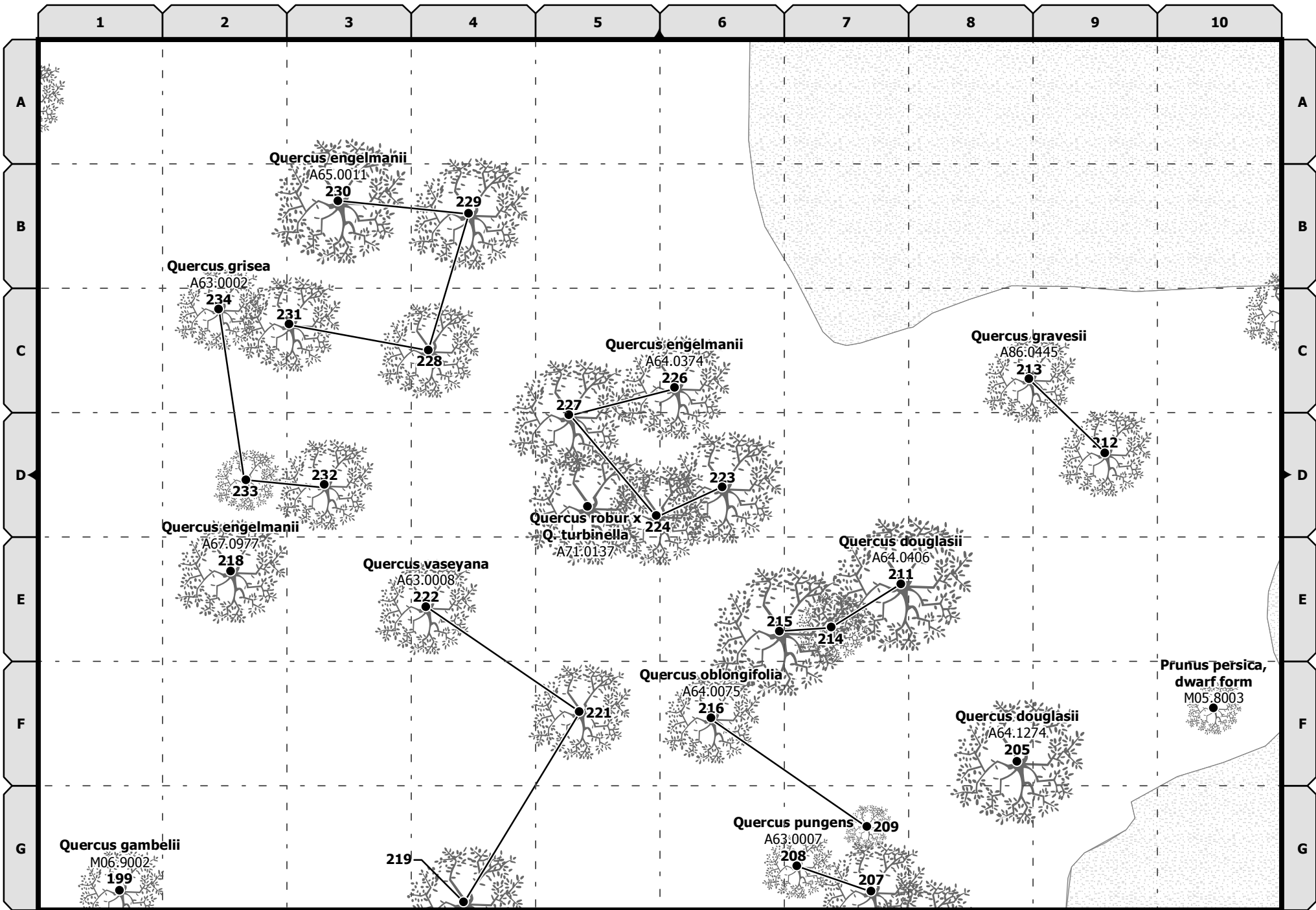

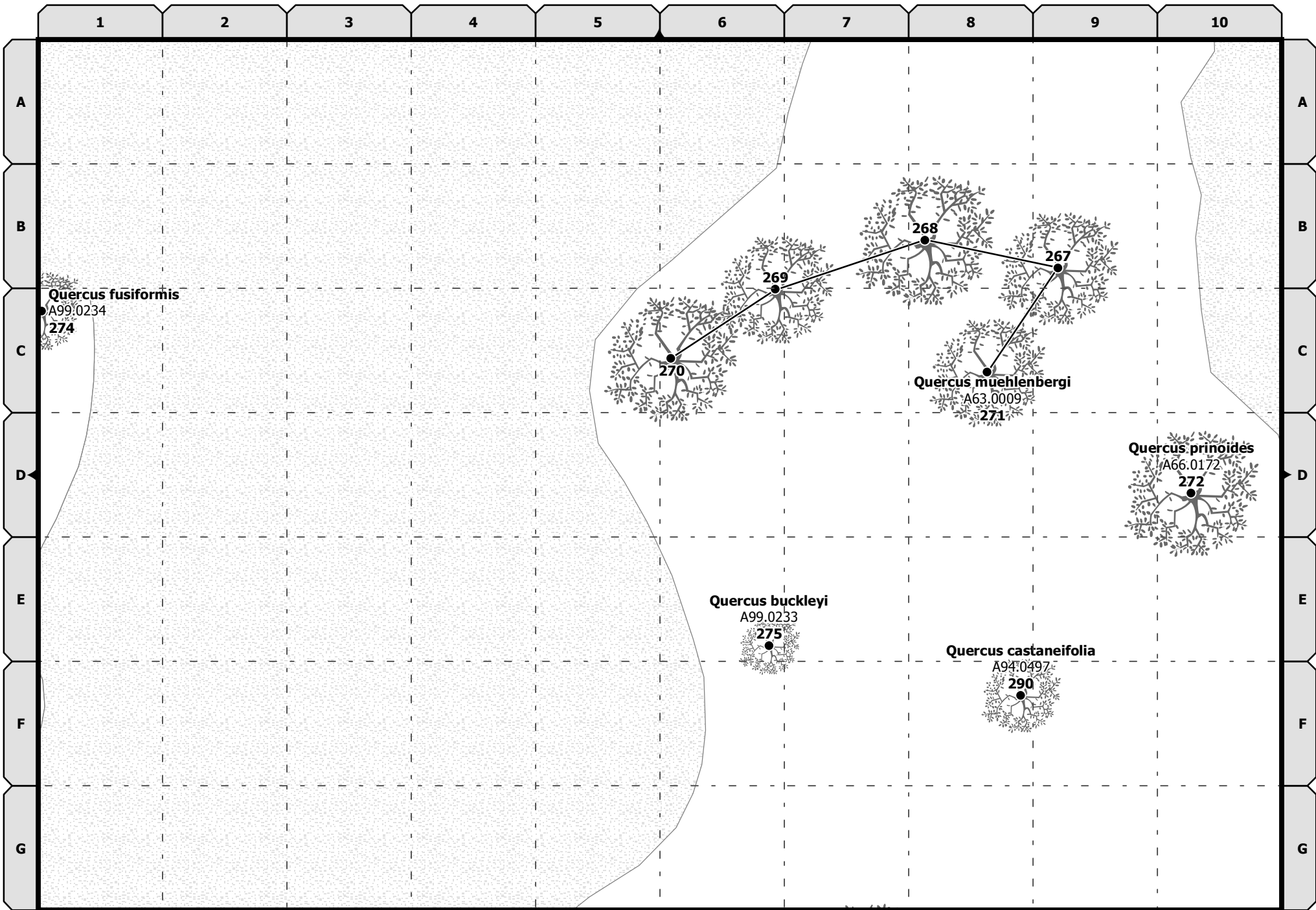

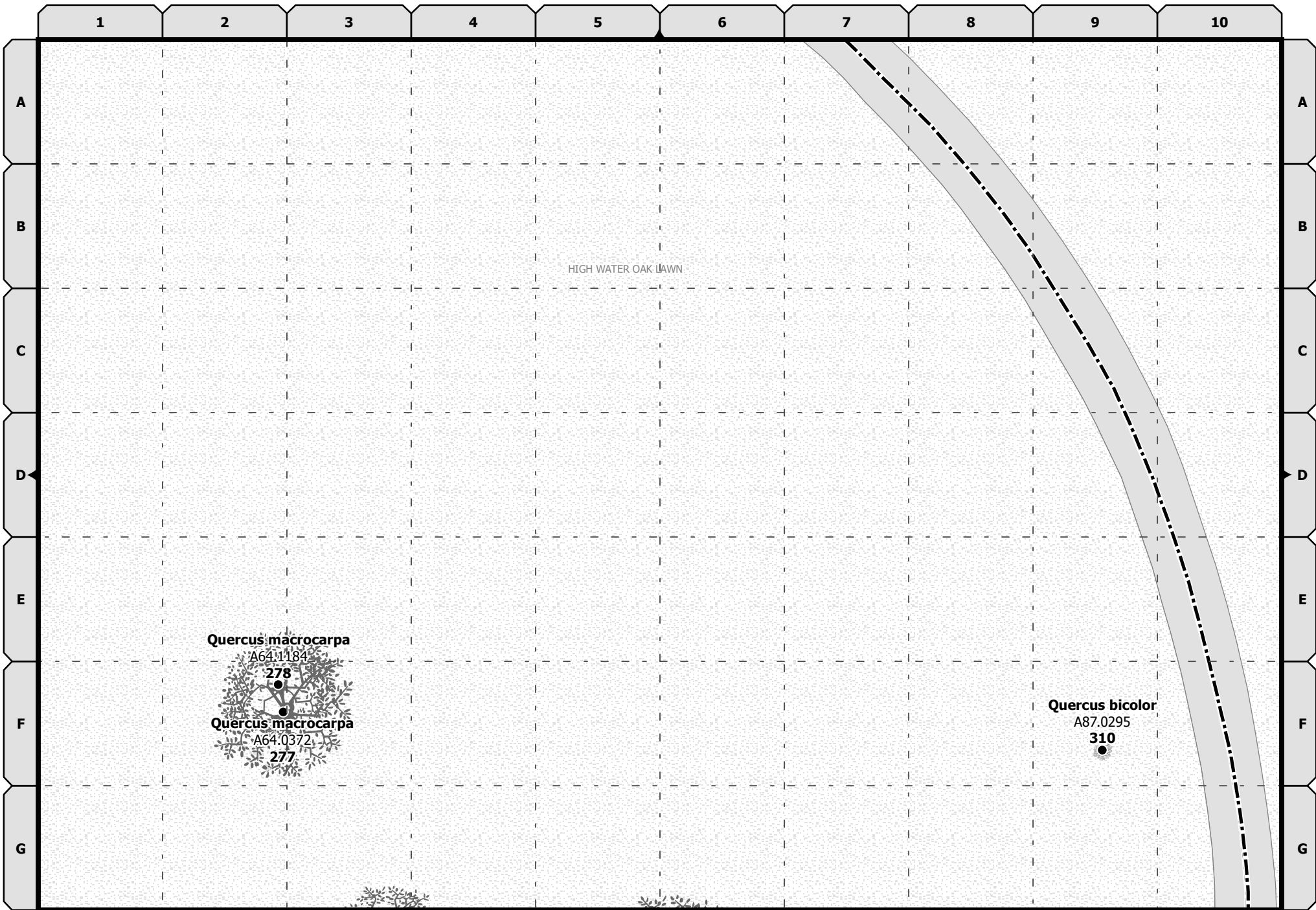

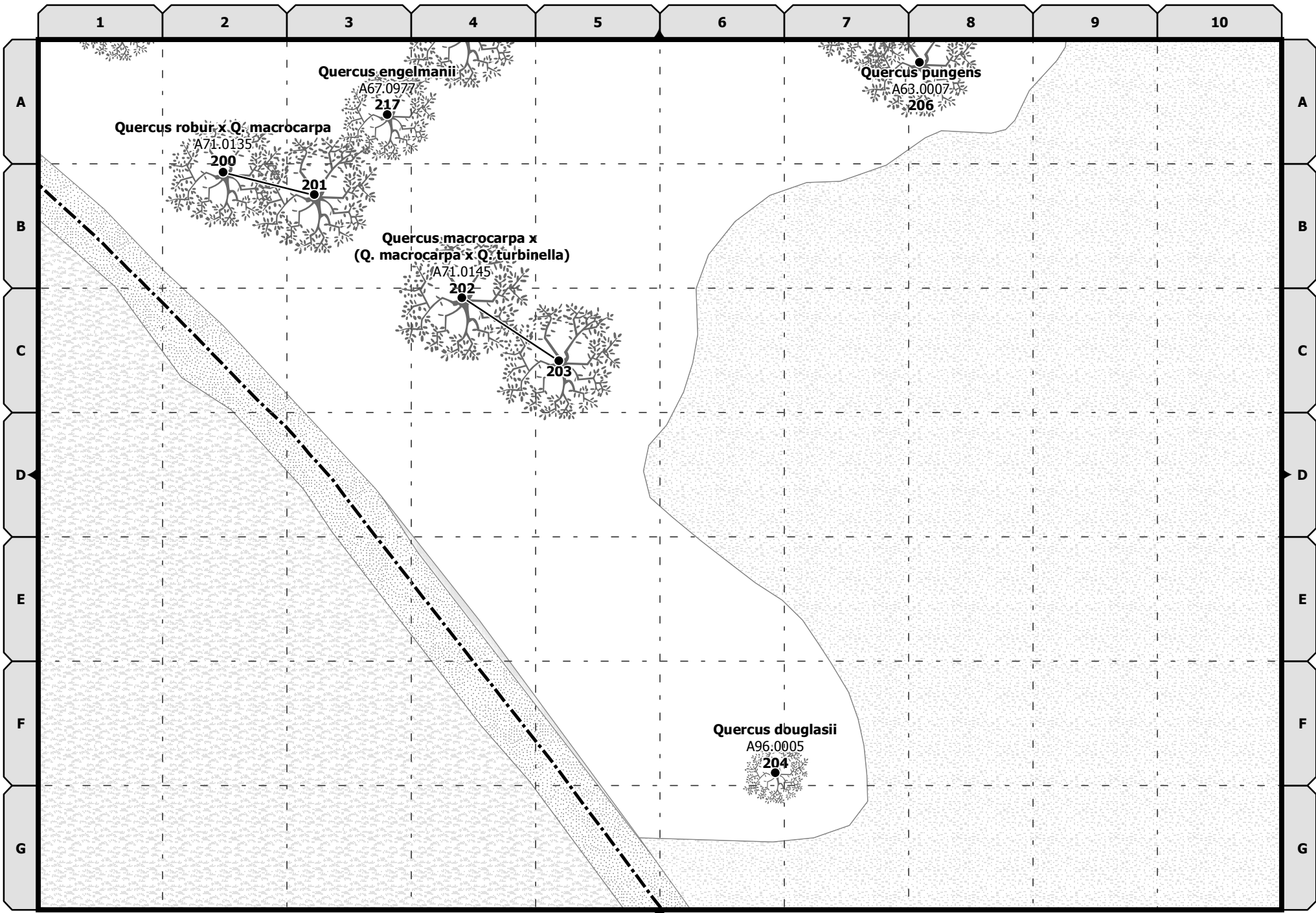

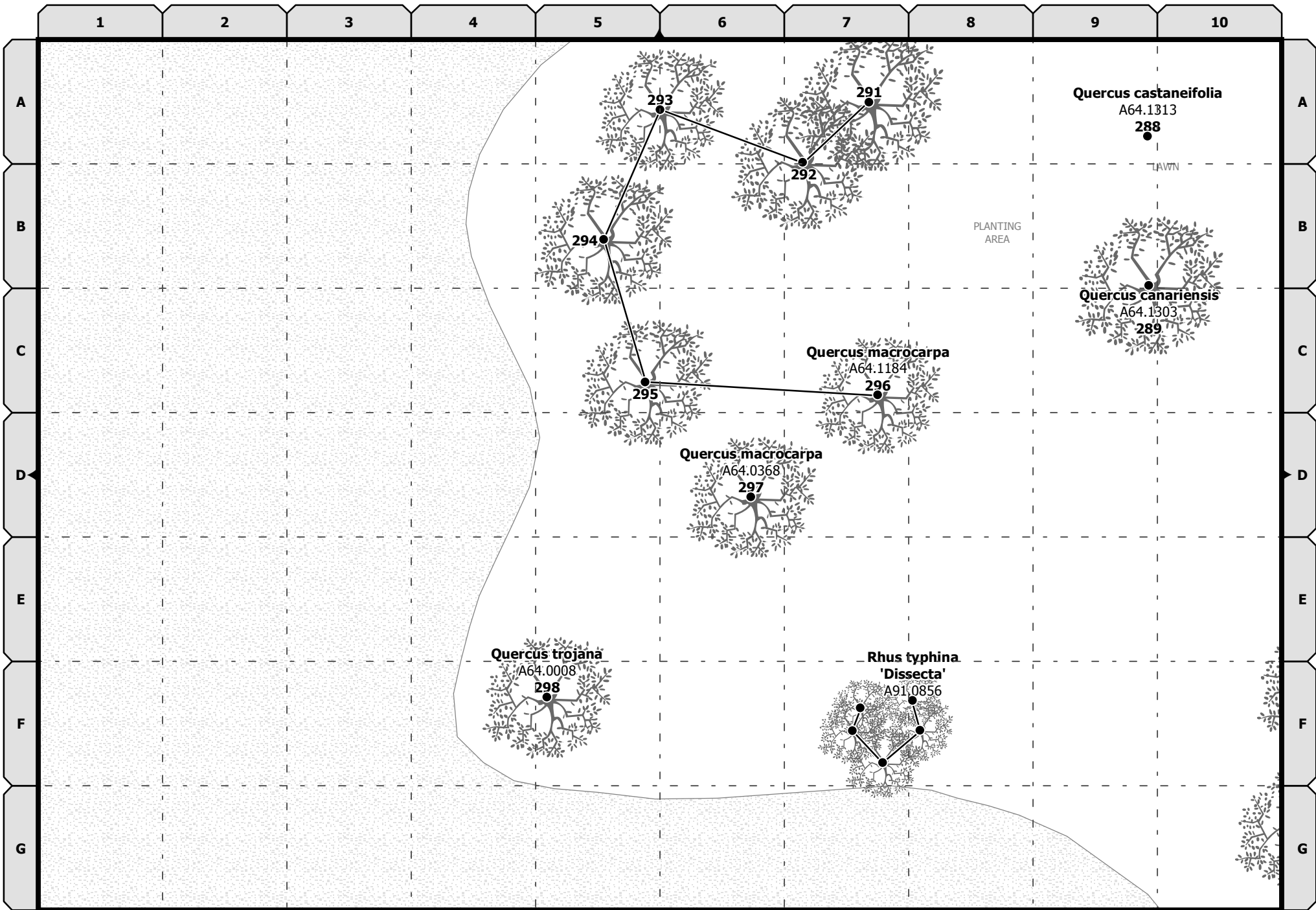

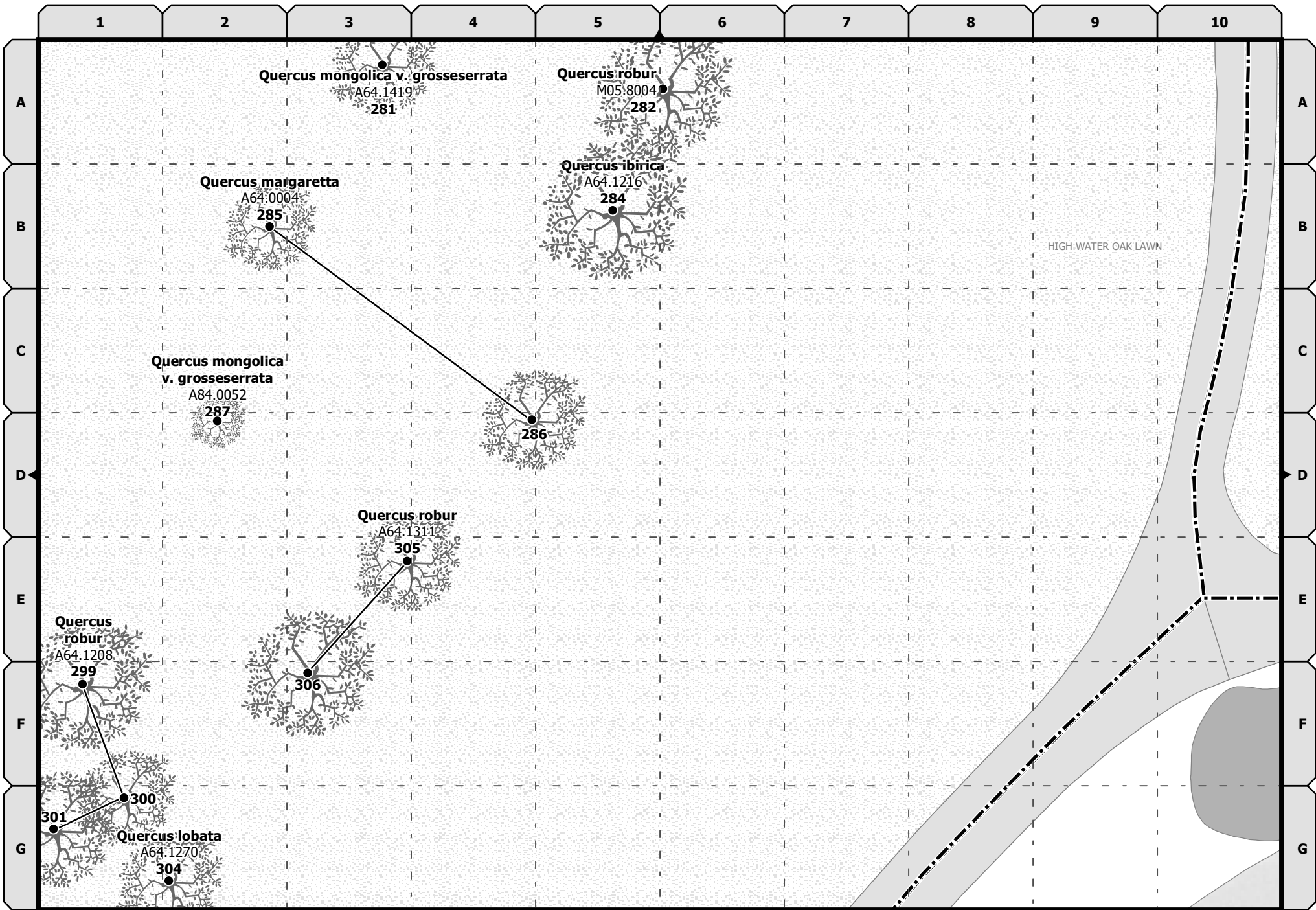

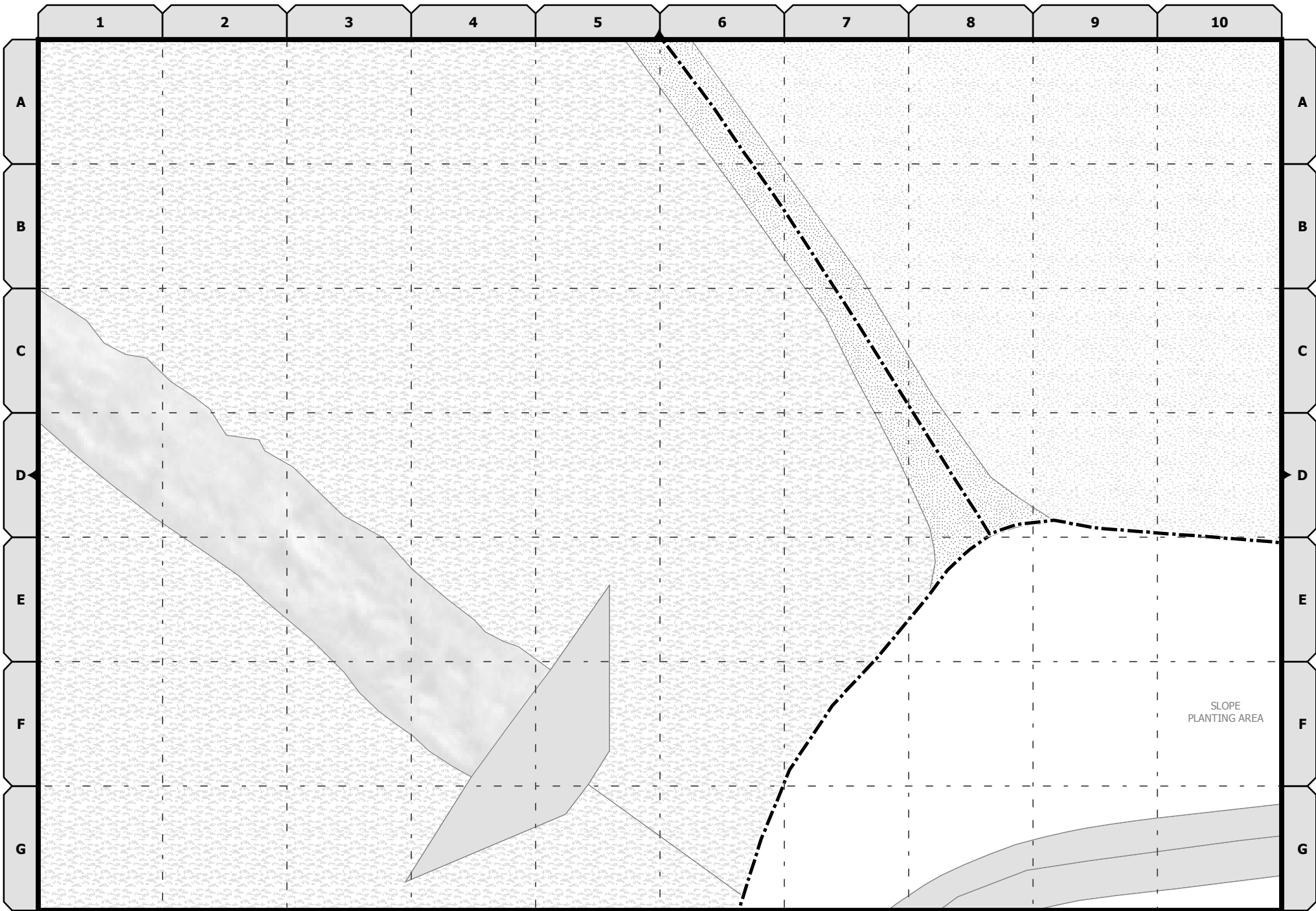

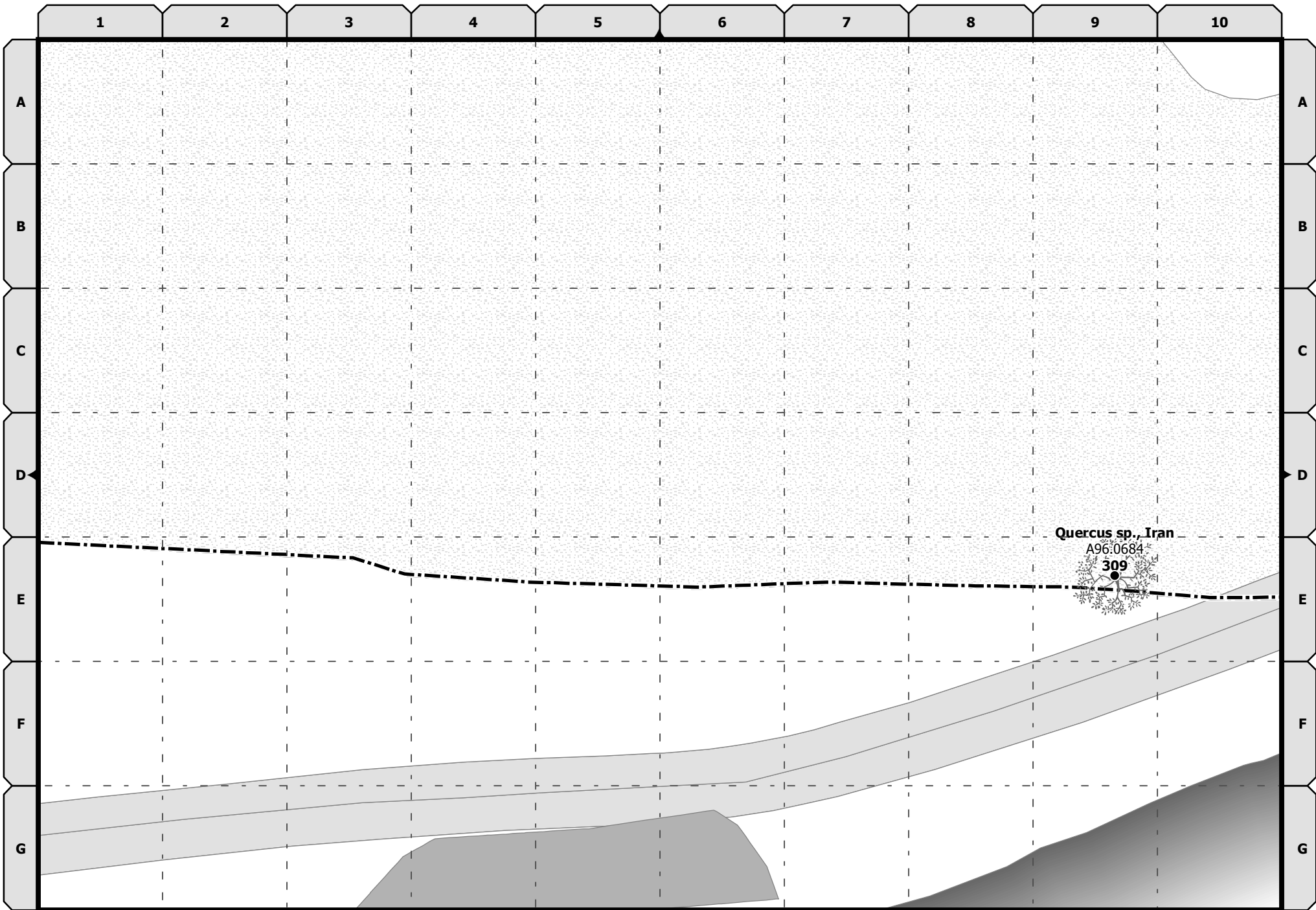

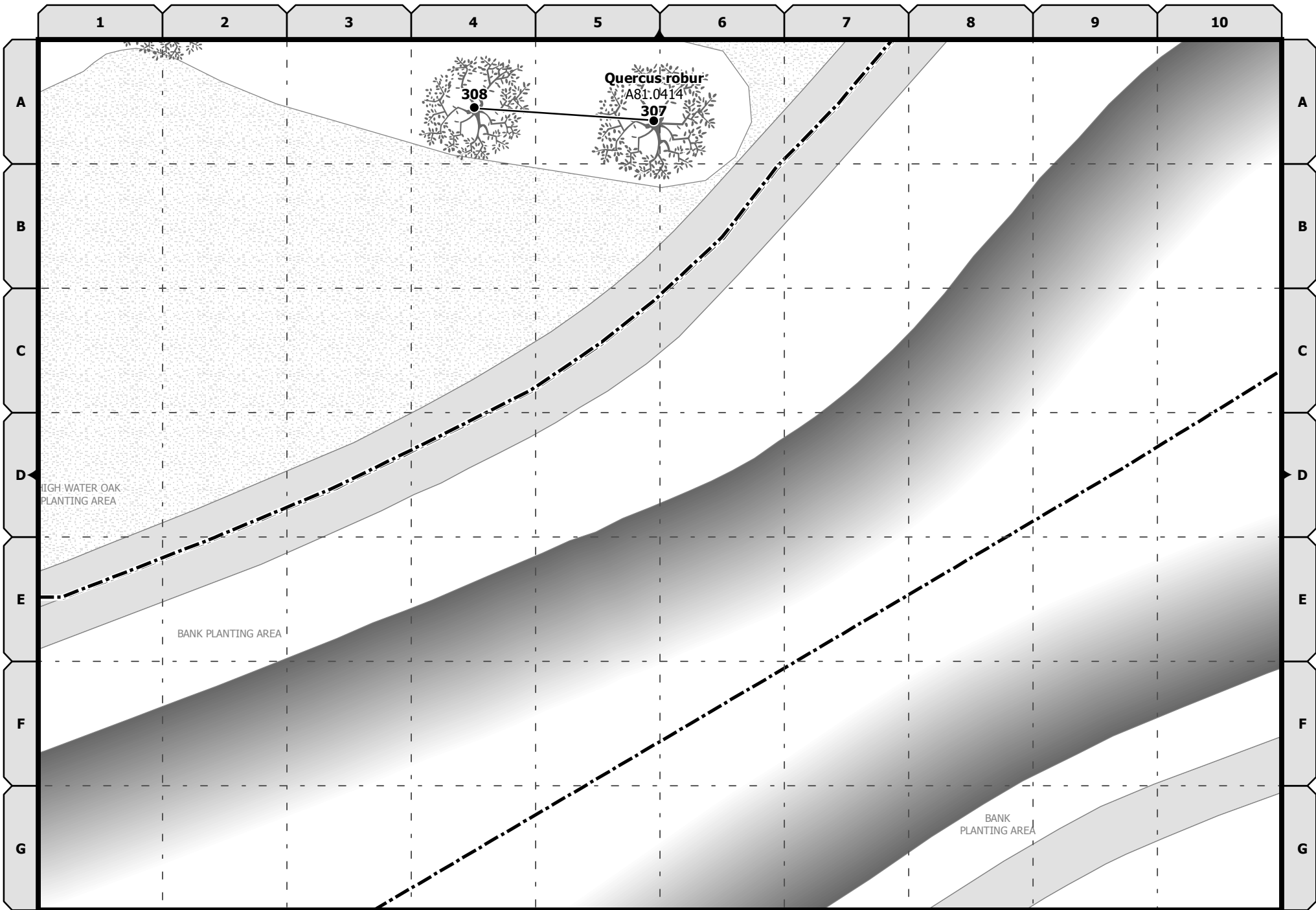







Specimen Name	Page	Specimen Name	Page	Specimen Name	Page	Specimen Name	Page	Specimen Name	Page
Ilex 'Clusterberry' A83.0018	6 G-4	Quercus agrifolia A64.1172	4 C-6 4 C-9 4 C-10	Quercus diversifolia A68.0353	8 B-10 8 D-10	Quercus gambelii x Q. robur A71.0129	7 A-10 8 D-1	Quercus infectoria ssp. veneris A64.1284	3 F-5 3 F-6
Iris unguicularis M05.8001	6 F-5 6 G-4	Quercus alba A64.1174	10 G-9	Quercus douglasii A64.0406	14 E-6 14 E-7	Quercus gambelii x Q. sp. M06.9003	8 G-2	Quercus ithaburensis A64.1285	10 A-3 10 B-3
L		Quercus bicolor A87.0295	16 F-9	Quercus douglasii A64.1274	14 F-8	Quercus gambelii A63.0004	3 D-9 3 E-9 3 F-9 3 G-9	Quercus ithaburensis A77.0495	5 G-9 10 A-5 10 D-3
Lagerstroemia indica 'Natchez' M05.8002	10 G-7	Quercus brandegei A67.0607	5 F-2 5 G-2	Quercus douglasii A96.0005	17 F-6	Quercus gambelii A71.0130	2 F-8	Quercus kelloggii x Q. wislizeni A64.1279	3 D-6 3 E-5
Lagerstroemia indica 'Seminole' A76.0018	6 G-1	Quercus buckleyi A99.0233	15 E-6	Quercus engelmannii A64.0374	11 B-1 14 C-6 14 D-5 14 D-6	Quercus gambelii A71.0131	8 F-2	Quercus lobata x Q. cornelius-mulleri A65.0932	2 F-10 3 G-2
Lagerstroemia indica A76.0016	10 A-6	Quercus canariensis A64.1303	18 B-9	Quercus engelmannii A65.0011	14 B-3 14 B-4 14 C-3 14 C-4	Quercus gambelii M06.9002	14 G-1	Quercus lobata A64.1270	19 G-2
Lagerstroemia 'Tuscarora' A88.0019	6 F-1 6 G-1 6 G-2	Quercus candicans A90.0489	9 B-5	Quercus engelmannii A67.0977	14 E-2 17 A-3	Quercus garryana A64.1161	3 F-9 8 A-4	Quercus macrocarpa x (Q. macrocarpa x Q. turbinella) A71.0145	17 C-4 17 C-5
P		Quercus castaneifolia A64.1313	6 F-5 6 G-5 6 G-6 18 A-9	Quercus engelmannii A67.1015	8 C-2	Quercus garryana A71.0132	3 D-7 3 D-8 3 E-7	Quercus macrocarpa x Q. gambelii A67.1029	3 D-1
Pinus canariensis A68.9023	21 G-2 21 G-8	Quercus castaneifolia A94.0497	15 F-8	Quercus faginea A71.0155	10 C-2	Quercus glandulifera A64.1306	9 F-4	Quercus macrocarpa x Q. lobata A67.1035	3 F-1
Populus fremontii A33.9040	20 G-9 21 E-7 21 F-2 21 F-4 21 F-6 21 G-6	Quercus cerris A64.1304	4 B-5 4 D-6	Quercus faginea A71.0165	10 D-4	Quercus gravesii A86.0445	14 C-8 14 D-9		
Prunus persica, dwarf form M05.8003	14 F-10	Quercus chrysolepis A65.0013	4 G-3	Quercus fusiformis A99.0234	15 C-1	Quercus greggii A68.0359	9 C-1 9 D-1		
Q		Quercus coccifera ssp. calliprinos A64.1286	5 E-1 5 E-2	Quercus gambelii x (Q. gambelii x Q. havardii) A71.0143	13 E-7	Quercus grisea A63.0002	14 C-2 14 D-2 14 D-3		
Quercus agrifolia v. oxyadenia A65.0014	4 F-9 4 F-10 4 G-9 4 G-10	Quercus coccifera A64.1324	5 G-8 10 A-3	Quercus gambelii x Q. macrocarpa A71.0127	3 B-7 3 C-9 3 G-5 7 A-5 7 A-6 7 B-7 7 B-8	Quercus ibirica A64.1216	19 B-5		
Quercus agrifolia A64.0713	5 D-10 6 C-1 6 C-2 6 D-2 6 E-1 6 F-2	Quercus crassifolia A66.0355	9 C-3	Quercus gambelii x Q. mongolica A71.0128	8 D-2	Quercus ilex v. ballota A64.1310	5 G-6 9 A-10		
		Quercus crassipes A68.0361	8 A-7 8 A-8 8 B-7			Quercus ilex A64.1315	5 F-4 5 F-6		
		Quercus deamii A69.0642	3 B-6			Quercus ilex A64.1326	5 E-5 5 E-7		







Specimen Name	Page	Specimen Name	Page	Specimen Name	Page	Specimen Name	Page	Specimen Name	Page
Quercus macrocarpa x Q. turbinella, F2 hybrids A81.0014	7 C-5	Quercus mongolica v. grosseserrata A64.1419	19 A-3	Quercus rober x Q. mongolica A71.0136	8 D-3 8 E-2	Quercus robur A64.1208	19 F-1 19 G-1	Quercus turbinella x Q. lobata A71.0138	13 E-8 13 F-9
	7 D-4								
	7 E-4	Quercus muehlenbergi A63.0009	15 B-6 15 B-8 15 B-9 15 C-6 15 C-8	Quercus robur f. fastigata A64.0371	4 B-7 5 A-8 5 A-9 5 A-10 5 B-2 6 A-1 6 A-2	Quercus robur A81.0414	22 A-4 22 A-5	Quercus turbinella x Q. stellata A71.0139	8 G-1 8 G-2
	7 E-5								
	7 E-6	Quercus myrsinifolia A64.0375	5 B-9 5 D-7	Quercus robur x Q. macrocarpa x Q. turbinella A71.0146	3 C-7	Quercus rugosa A65.0838	10 B-5	Quercus turbinella x Q. suber A67.1045	3 B-3
	7 F-3								
	7 F-7	Quercus obtusata A68.0350	8 B-6 8 C-6 8 D-5 8 D-6 8 D-8	Quercus robur x Q. macrocarpa A67.1036	3 F-3	Quercus sinuata A64.0062	4 C-9	Quercus turbinella x Q. virginiana A71.0140	8 E-1 8 E-2 13 C-7 13 D-6 13 D-8
	7 G-5								
	7 G-6	Quercus phillyreoides M05.8007	5 B-5	Quercus robur x Q. mongolica A71.0136	3 D-8	Quercus suber A64.1280	4 D-6	Quercus turbinella A67.1039	2 A-10
	7 G-7								
	7 G-8	Quercus prinoides A66.0172	15 D-10	Quercus robur x Q. mongolica A71.0136	3 B-8 3 C-5 17 B-2 17 B-3	Quercus tomentella A68.0609	5 F-8	Quercus variabilis A69.0181	9 E-6 9 E-7
	12 A-7								
12 A-8	Quercus phillyreoides M05.8009	5 C-5	Quercus robur x Q. mongolica A71.0136	3 D-8	Quercus trojana A64.1309	8 A-5 8 A-6	Quercus virginiana A64.0012	5 D-3 5 E-4	
12 A-9									Quercus phillyreoides M05.8009
12 A-10	Quercus phillyreoides M05.8009	5 C-5	Quercus robur x Q. mongolica A71.0136	3 D-8	Quercus turbinella x Q. gambelii A67.1041	3 C-5	Quercus x acutidens A67.0978	8 B-2 8 C-2	
12 B-7									Quercus pungens A63.0007
12 B-8	Quercus pungens A63.0007	14 G-7 17 A-8	Quercus robur x Q. mongolica A71.0136	3 D-8	Quercus turbinella x Q. garryana A67.1033	3 B-1 3 C-1	Quercus x hispanica A98.0112	3 G-9	
12 B-10									Quercus pungens A63.0007
12 C-9	Quercus pungens A63.0007	14 G-7 17 A-8	Quercus robur x Q. mongolica A71.0136	3 D-8	Quercus turbinella x Q. garryana A67.1033	3 B-1 3 C-1	Quercus x hispanica A98.0112	3 G-9	
12 C-10									Quercus pungens A63.0007
13 B-1	Quercus pungens A63.0007	14 G-7 17 A-8	Quercus robur x Q. mongolica A71.0136	3 D-8	Quercus turbinella x Q. garryana A67.1033	3 B-1 3 C-1	Quercus x hispanica A98.0112	3 G-9	
									Quercus pungens A63.0007

Specimen Name	Page
Rhus typhina 'Dissecta' A91.0856	18 F-7 18 F-8
S	
Symphoricarpos x chenaultii A86.0447	6 G-4
V	
Viburnum plicatum 'Mariesii' A80.0072	6 G-5
Vitis californica M05.8006	21 G-5



Plants

-  Herbaceous
-  Graminoid
-  Vine
-  Shrub
-  Tree
-  Mass Plantings







Amenities

-  Bench
-  Bollard
-  Drinking Fountain
-  Picnic Table
-  Public Restroom
-  Trash Can
-  Fence







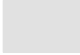

Irrigation

-  Sprinkler Head
-  Quick Coupler Valve
-  Irrigation Control Valve
-  Water Main
-  Hose Valve
-  Backflow Preventer

Utilities

-  Drain Inlet
-  Drain Outlet
-  Light
-  Manhole
-  Utility Box
-  Utility Pole







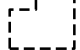





Surfaces

-  Primary Pathway
-  Secondary Pathway
-  Unimproved Pathway
-  Soil
-  Turf
-  Wild Area
-  Unplantable Surface
-  Structures
-  Waterway

Boundaries

-  Section Boundary
-  Page Boundary

Signs

-  Plant Label
-  Collection
-  Wayfinding
-  Orientation
-  Interpretive
-  All-Stars
-  Vintage Informational
-  Visitor Map
-  Kiosk
-  Regulatory
-  Temporary
-  Commemorative

UC DAVIS ARBORETUM SECTIONS

